



ORDINANCE NO. 1179

AN ORDINANCE OF THE CITY OF FARMERS BRANCH, TEXAS, AMENDING THE COMPREHENSIVE ZONING ORDINANCE OF THE CITY OF FARMERS BRANCH, TEXAS, AS HERETOFORE AMENDED; BY AMENDING THE ZONING DISTRICT CLASSIFICATION OF THE TRACT OF LAND BOUNDED ON THE NORTH BY THE CENTERLINE OF VALLEY VIEW LANE, ON THE EAST BY THE CENTERLINE OF INTERSTATE HIGHWAY 35E, ON THE WEST BY THE EAST RIGHT-OF-WAY LINE OF THE CHICAGO, ROCK ISLAND AND PACIFIC RAILROAD AND ON THE SOUTH BY THE SOUTHERN CITY LIMITS OF THE CITY OF FARMERS BRANCH, FROM ITS CURRENT ZONING DISTRICT CLASSIFICATION OF LIGHT INDUSTRIAL (LI) TO A CLASSIFICATION OF PLANNED DEVELOPMENT DISTRICT ALLOWING LIGHT INDUSTRIAL USES; ESTABLISHING A PENALTY OF FINE NOT TO EXCEED THE SUM OF TWO HUNDRED DOLLARS (\$200.00) FOR EACH OFFENSE; PROVIDING FOR SEVERABILITY; AND DECLARING AN EMERGENCY.

WHEREAS, the City Planning and Zoning Commission of the City of Farmers Branch, in compliance with the Charter of the City of Farmers Branch, and the State Law with reference to the granting of changes of zoning under the Zoning Ordinance regulations and Zoning Map, have given the requisite notices by publication and otherwise, and after holding due hearings and affording a full and fair hearing to all the property owners generally, and to the persons interested and situated in the affected area and in the vicinity thereof, the governing body of the City of Farmers Branch is of the opinion that due to a change in condition and in order to protect the public health, welfare and safety, said changes of zoning should be granted, as set out herein:

NOW, THEREFORE, BE IT ORDAINED BY THE CITY COUNCIL OF THE CITY OF FARMERS BRANCH, TEXAS:

SECTION 1. That the Comprehensive Zoning Ordinance of the City of Farmers Branch, Texas, be and the same is hereby amended by amending the

Zoning Map of the City of Farmers Branch, Texas, so as to change the zoning on the following described tract of land from Light Industrial (LI) to Planned Development Zoning District Number Twenty-four, allowing Light Industrial Uses (PD-24, (LI)). Said Tract of land being described as follows:

The tract of land bounded on the north by the centerline of Valley View Lane, on the east by the centerline of Interstate Highway 35E, on the west by the east right-of-way line of the Chicago, Rock Island and Pacific Railroad and on the south by the southern city limits of the City of Farmers Branch.

SECTION 2. That all uses in Planned Development Zoning District Number Twenty-four (PD-24) shall conform in operation, location and construction to the performance standards established by the Comprehensive Zoning Ordinance of the City of Farmers Branch.

SECTION 3. That the above described tract of land shall be used only in the manner and for the purposes provided by the Comprehensive Zoning Ordinance of the City of Farmers Branch, as heretofore amended and as amended herein.

SECTION 4. That any person, firm or corporation violating any of the provisions or terms of this ordinance shall be subject to the same penalty as provided for in the Comprehensive Zoning Ordinance of the City of Farmers Branch, and upon conviction shall be punished by a fine not to exceed Two Hundred Dollars (\$200.00) for each offense.

SECTION 5. If any section, paragraph, subdivision, clause, phrase or provision of this ordinance shall be judged invalid or unconstitutional, the same shall not affect the validity of this ordinance as a whole or any part or portion thereof, other than that portion so decided to be invalid or unconstitutional.

SECTION 6. Injunctive Relief. In addition to and accumulative of all other penalties, the City shall have the right to seek injunctive relief for any and all violations of this ordinance.

SECTION 7. Whereas, it has been found that there has been a change in conditions in the above described property, it is now necessary that it be given the above zoning classification in order to permit its proper development, and in order to protect the public interest, comfort and general welfare, of the City of Farmers Branch, and creates an urgency and an emergency in the preservation of the public health, safety and welfare, and requires that this ordinance shall take effect immediately from and after its passage, and publication of the caption of said ordinance as the law in such cases provides.

DULY PASSED by the City Council of the City of Farmers Branch, Texas, on this the 6th day of February, 1978.

APPROVED:

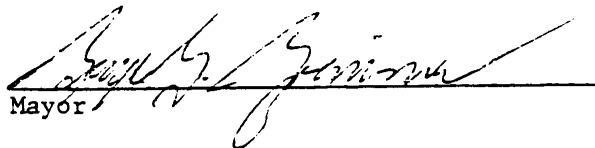
  
\_\_\_\_\_  
Mayor

ATTEST:

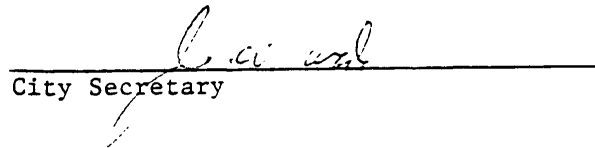
  
\_\_\_\_\_  
City Secretary

APPROVED AS TO FORM:

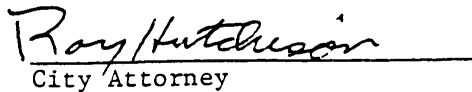
  
\_\_\_\_\_  
City Attorney

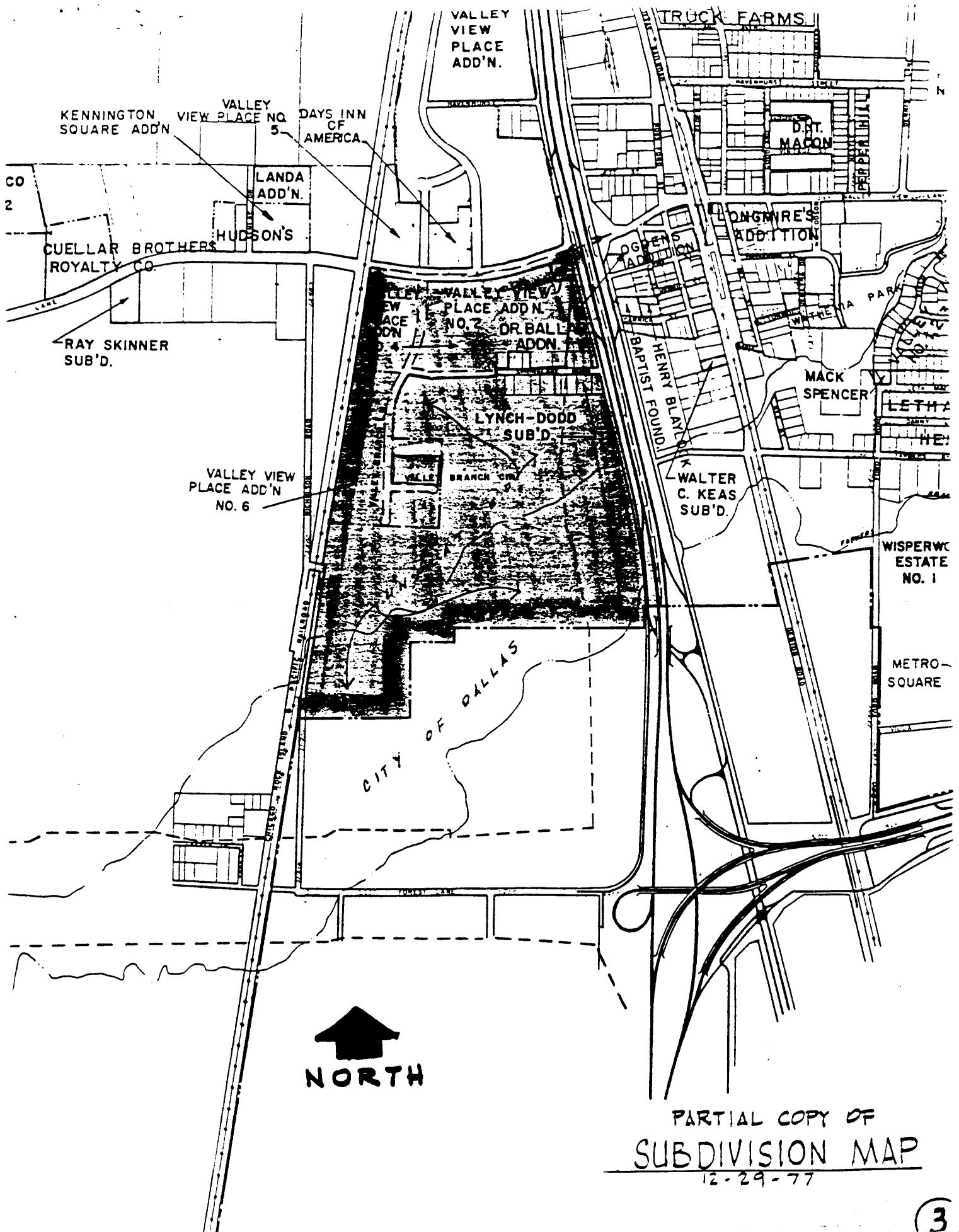

VALLEY VIEW PLACE ADD'N.

TRUCK FARMS

KENNINGTON SQUARE ADD'N

VALLEY VIEW PLACE NO. 5

DAYS INN OF AMERICA

CO  
2

LANDA ADD'N.

HUDSON'S

CUELLAR BROTHERS ROYALTY CO

RAY SKINNER SUB'D.

VALLEY VIEW PLACE ADD'N NO. 6

CITY OF DALLAS



PARTIAL COPY OF  
SUBDIVISION MAP  
12-29-77